

SMARTLIBERTY

— MORE TIME FOR CARE —

# Resident badge

## User documentation

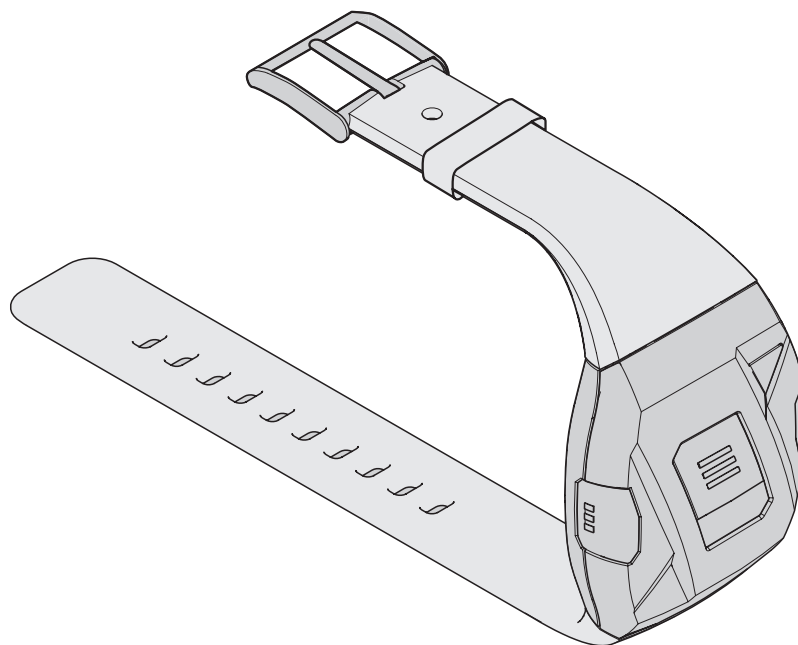

## 1. Description

### Intended use

The SmartLiberty resident badge allows residents to place a mobile resident call or a localised service call. This badge can be configured to detect residents who are disoriented.

### Reference documents

Document	Description / Document no.
Data sheet	Technical features of the resident badge

### Overview

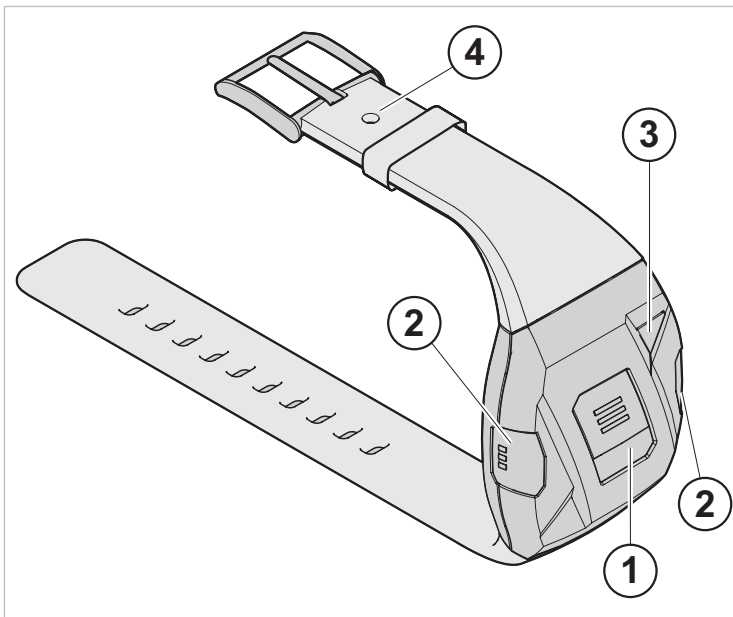

Fig. 1 Resident badge

- 1 Resident call button
- 2 Service call button
- 3 Reassurance light (LED)
- 4 Hole for safety clasp

### Functions

The SmartLiberty resident badge is provided with the following functions:

- a resident call button
- a service call double-button
- a tamper sensor to monitor whether the badge is being worn

### Power

- Battery CR2450, 3 V, 500 mAh (replaceable). Only use batteries approved by the manufacturer (see SmartLiberty website).

## 2. Use



### CAUTION

Risk of malfunction if the infrared receiver is covered!

- ▶ Wear the badge so that it is visible.
- ▶ Do not cover the badge and do not stick anything on the reassurance light (LED).

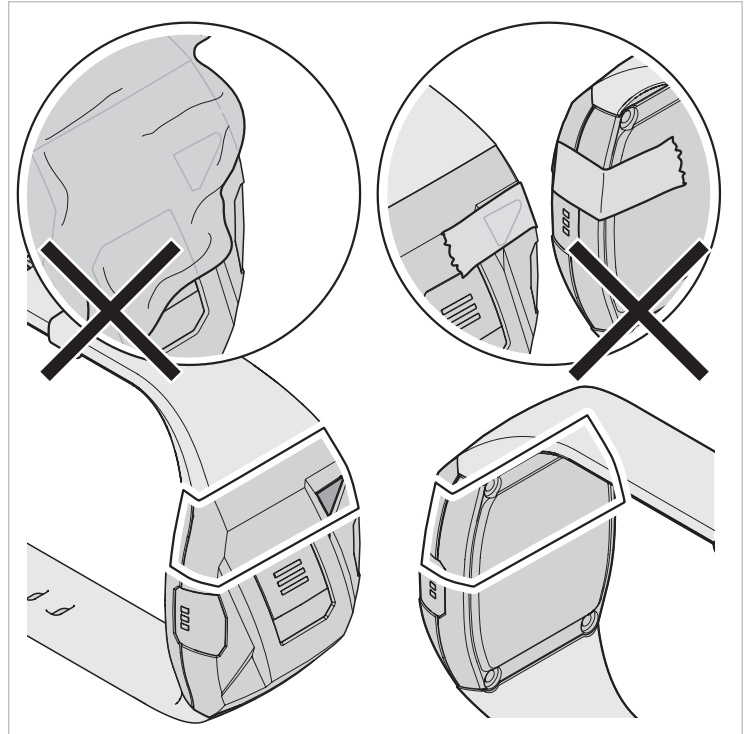

Fig. 2 Do not cover the badge

### Activating the badge

- ▶ Press the resident call button (1, Fig. 1) for 10 sec. until the reassurance light (LED) lights up.  
*When activated, the reassurance light (LED) flashes green.*

### i

Before putting into service, 2 more stages absolutely must be completed:

- ▶ Enter the badge into the software.
- ▶ Assign the badge.  
*See the software manual.*

### Sending a resident call

- ▶ Press the button for resident call in the badge centre (1, Fig. 1).  
*The reassurance light (LED) lights up red.*
- The call has been received by the server.  
*The reassurance light (LED) lights up red.*
- The call has been taken over and someone will arrive to provide assistance.  
*The reassurance light (LED) flashes blue (after a short period).*
- The call has been cancelled.  
*The reassurance light (LED) flashes green for several seconds.*

### Sending a service call

The service call must be activated in the system configuration, otherwise a resident call is generated.

- ▶ Press one of the two service call buttons on the sides of the badge (2, Fig. 1).  
*The reassurance light (LED) lights up red.*
- The call has been received by the server.  
*The reassurance light (LED) lights up red.*
- The call has been taken over and someone will arrive to provide assistance.  
*The reassurance light (LED) flashes blue (after a short period).*
- The call has been cancelled.  
*The reassurance light (LED) flashes green for several seconds.*

## 3. Attachment

The resident badge can be worn:

- on the wrist as a wristband (with optional safety clasp) or disposable bracelet,
- on the belt using the clip,
- as a pendant, around the neck (with anti-strangulation feature).

The attachment brackets are required to mount:

- the disposable bracelet (2x)
- the belt clip (1x)
- the pendant (2x)

By default the bracelet is mounted on the badge.

### Mounting the attachment brackets

**i**

- ▶ If the wristband is not attached, be sure first to mount the two brackets to the badge.

1. Open the badge.  
*See «4. Opening/closing the badge».*
2. Fitting both brackets on the badge.

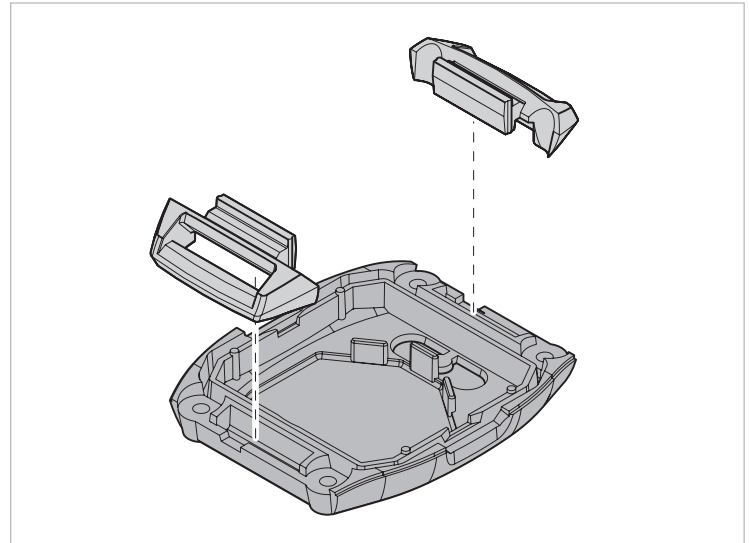

Fig. 3 Attachment loops

3. Close the badge again.  
*See «4. Opening/closing the badge».*

### Mounting the disposable bracelet

1. Insert the disposable bracelet into the 2 attachment brackets.

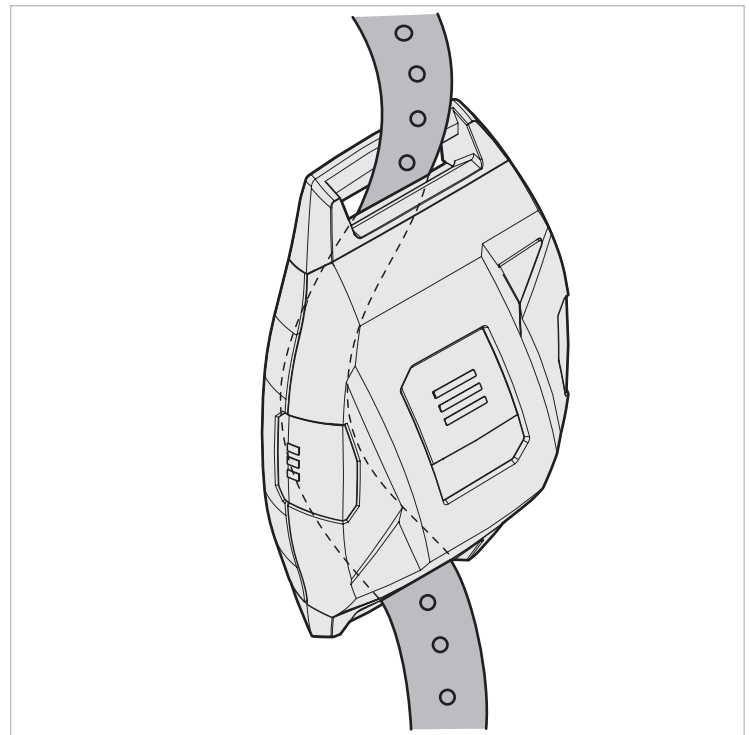

Fig. 4 Disposable bracelet

2. Adjust the disposable bracelet on the wrist and close it.

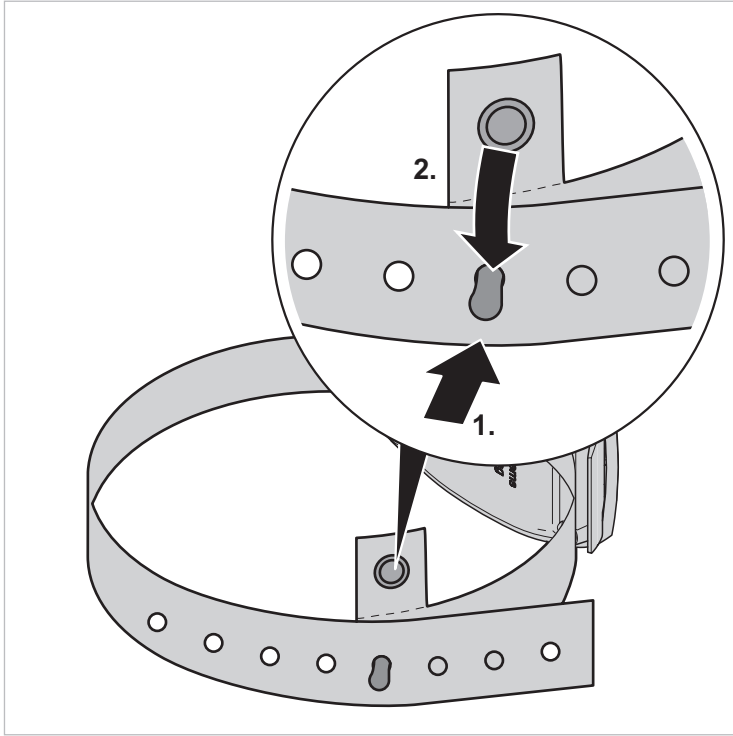

Fig. 5 Closing the disposable bracelet

3. Cut the bracelet to remove it.

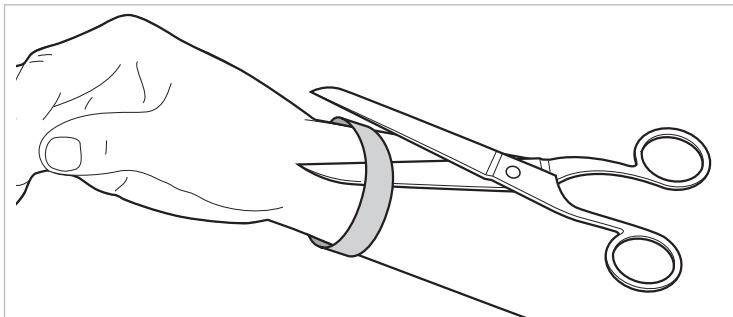

Fig. 6 Cutting the disposable bracelet

### Mounting the belt clip

1. Fit a bracket and the belt clip to the back of the badge.

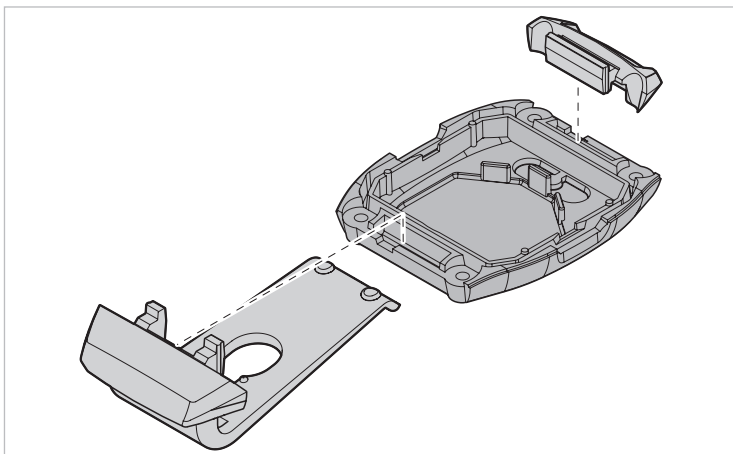

Fig. 7 Mounting of the bracket and the belt clip

2. Close the badge again.  
See «4. Opening/closing the badge».

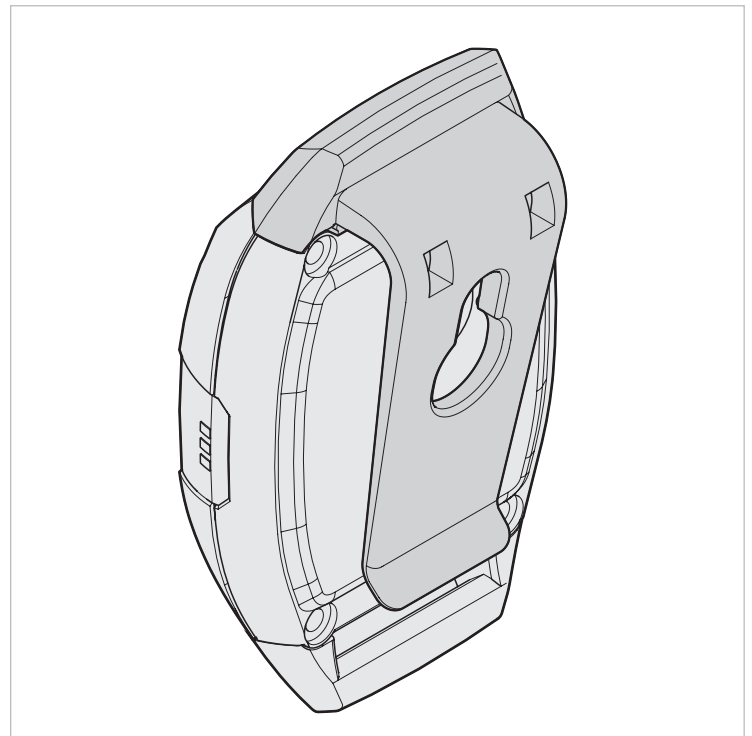

Fig. 8 Belt clip

### Mounting the pendant

- ▶ Insert the snap clasp of the pendant into the upper attachment bracket of the badge.

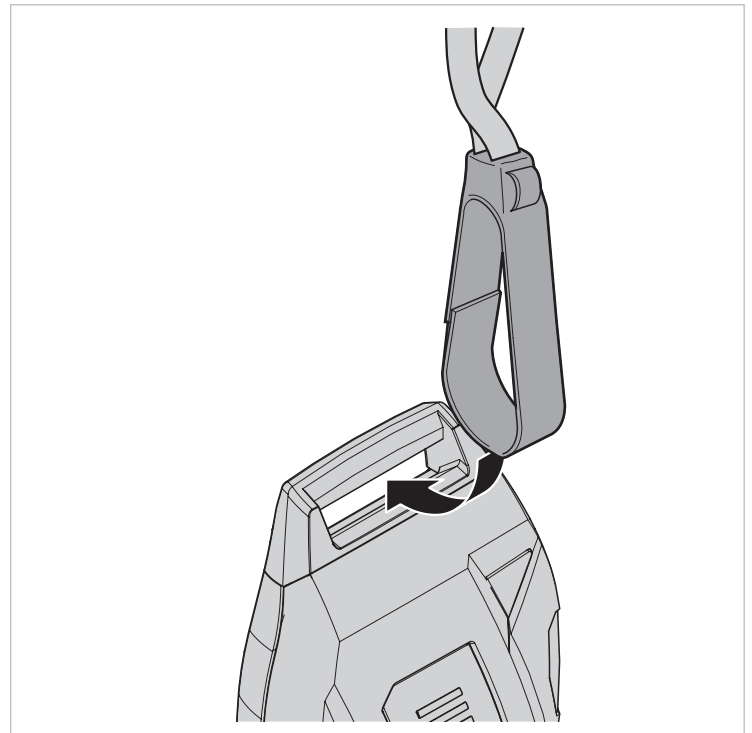

Fig. 9 Pendant around the neck

**Mounting the wristband**

1. Open the badge.  
See «4. Opening/closing the badge».
2. Fit both parts of the wristband on the badge. Place the shorter part of the bracelet (with hole for the safety clasp) on the side with the recess for the battery.

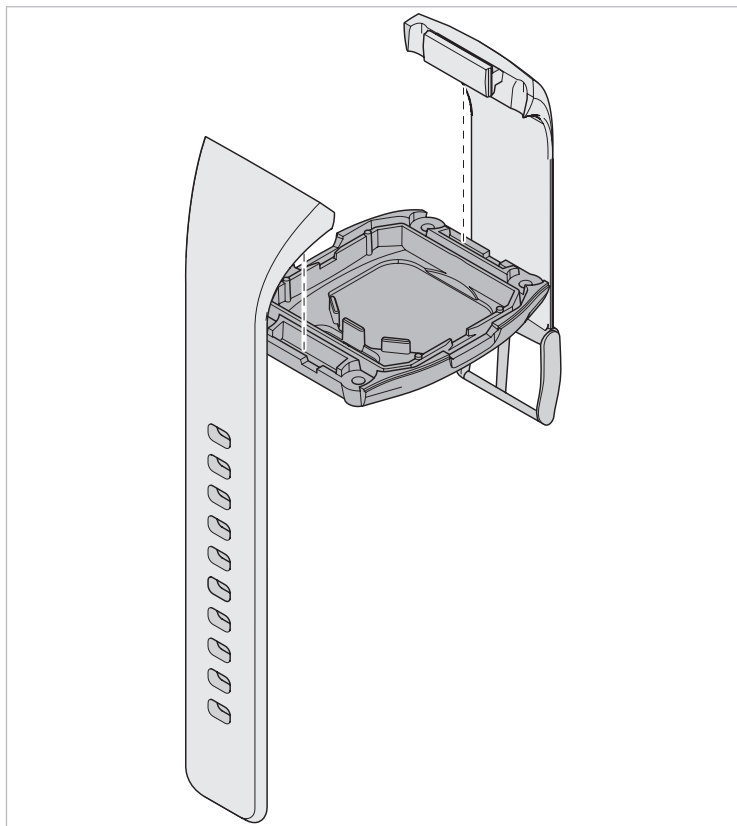

Fig. 10 Wriststrap

3. Close the badge again.  
See «4. Opening/closing the badge».

**Securing the wristband**

1. Attach the wristband to the arm of the resident.
2. Slip the security lock under the wristband.
3. Close the security lock.

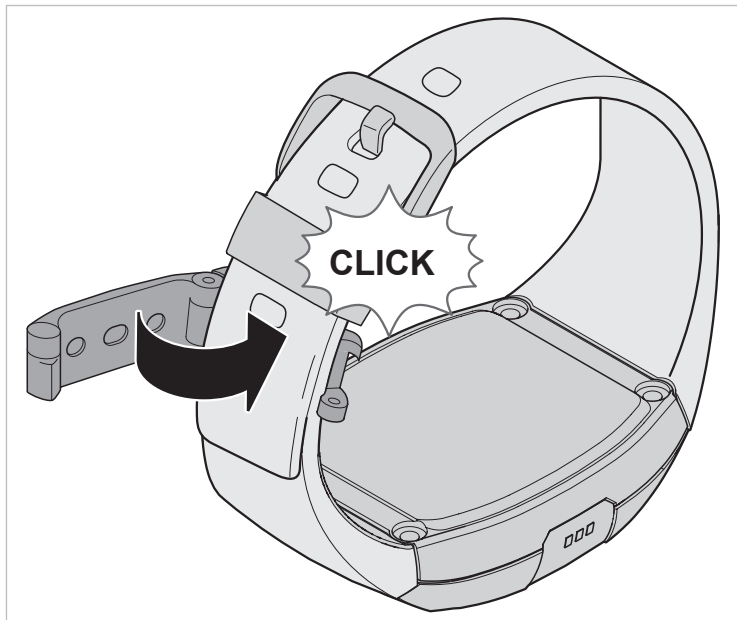

Fig. 11 Closing the security lock

4. To open the security lock, use the key.

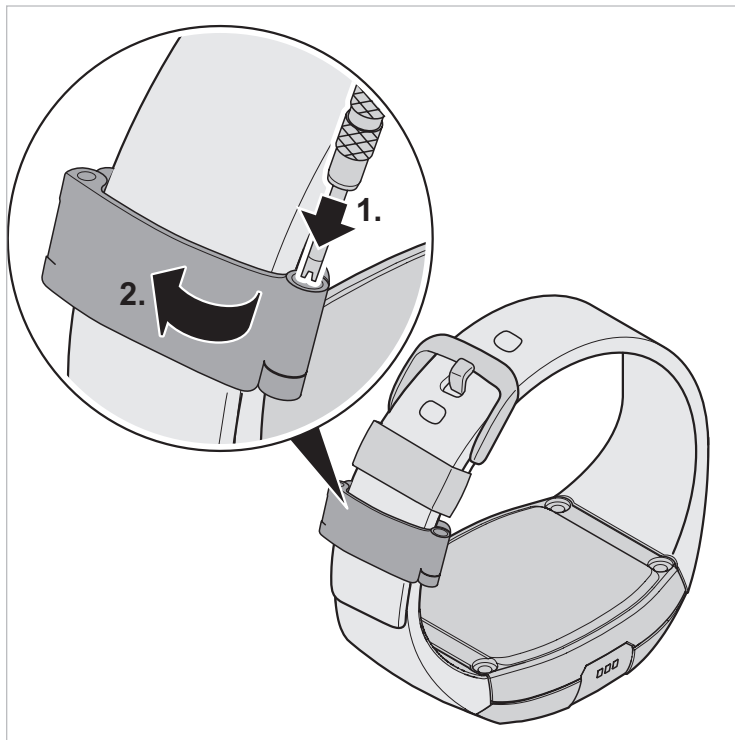

Fig. 12 Opening the security lock

**4. Opening/closing the badge**

The badge must be opened in order to:

- change the wristband/brackets
- change the battery

**Opening the badge**

1. Press the badge into the opening tool.  
The "SmartLiberty" inscription on the tool faces upwards on the badge with wristband and downwards on the badge with belt clip.
2. Use a Torx T6 screwdriver to unscrew the bottom of the housing.

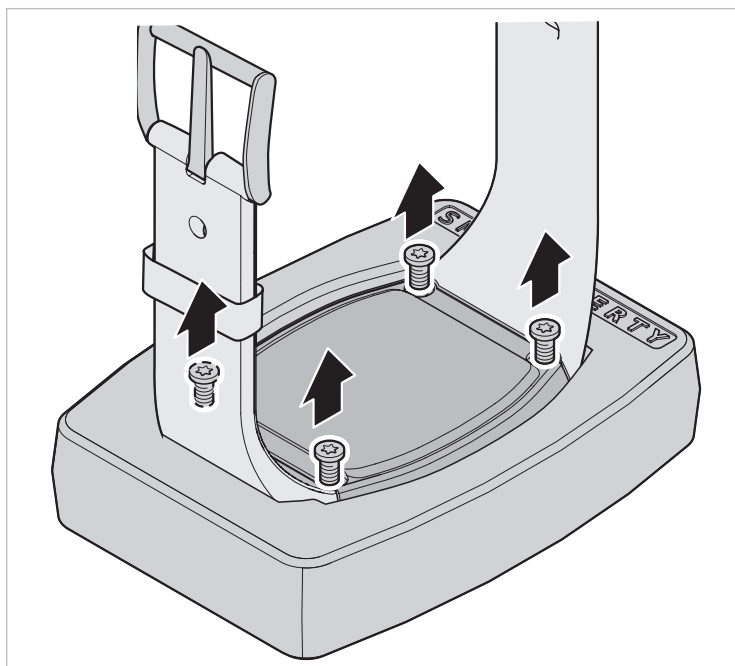

Fig. 13 Unscrewing the badge when attached to the wristband

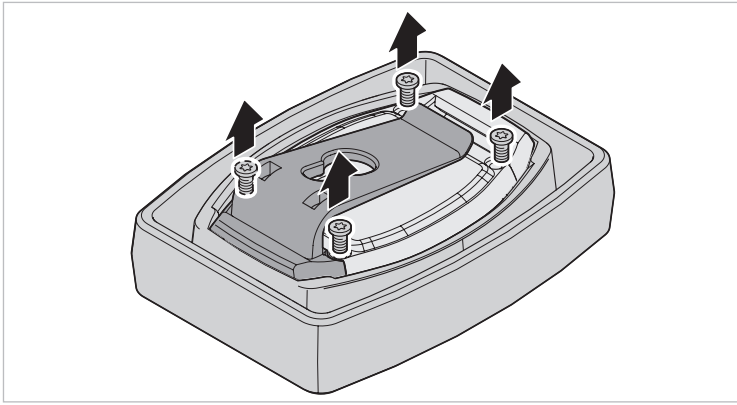

Fig. 14 Screwing on badge with the belt clip attachment

3. Press out the badge. This requires manual pressure with the badge opening set.

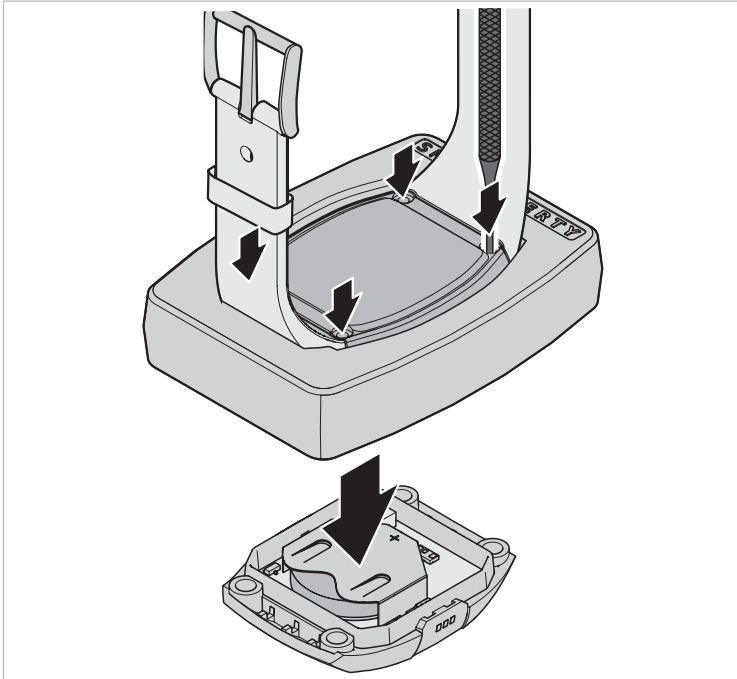

Fig. 15 Pushing out badge when attached to the wristband

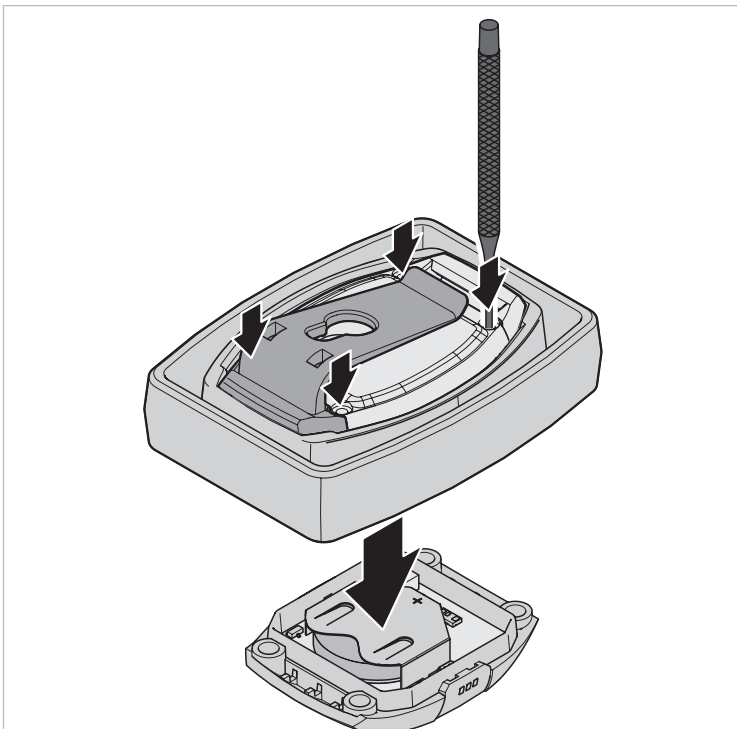

Fig. 16 Pushing out badge when attached to belt clip

## Closing the badge

1. Make sure that the back of the badge is placed back in the right direction.

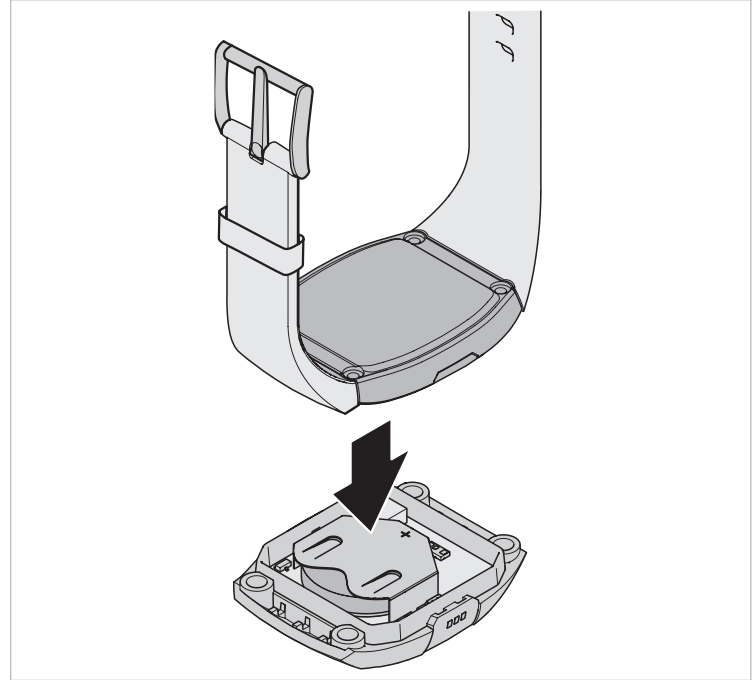

Fig. 17 Aligning the lower part of the badge

2. Firmly press both parts of the badge together to ensure that the housing is sealed.
3. Use a Torx T6 screwdriver to uniformly tighten the screws in an even cross-like pattern.

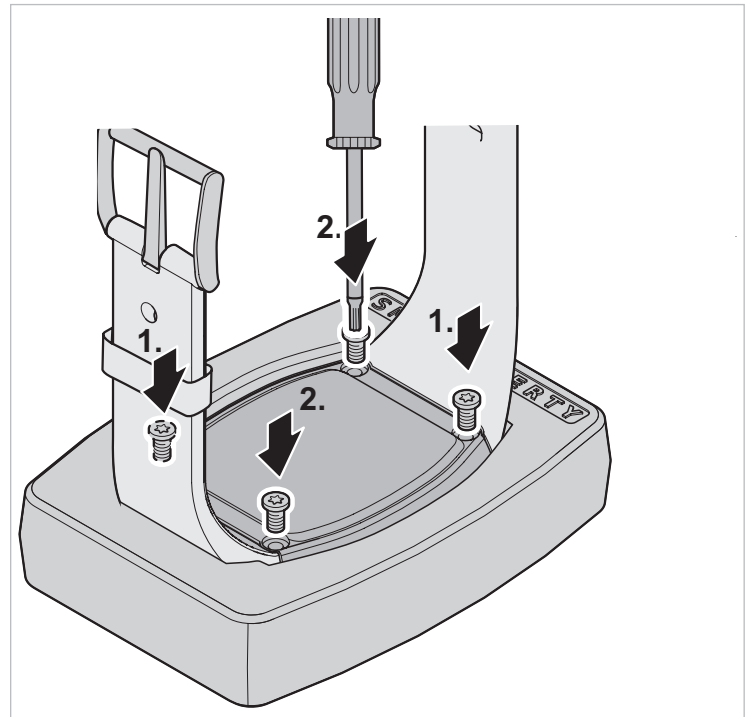

Fig. 18 Closing badge when attached to wristband



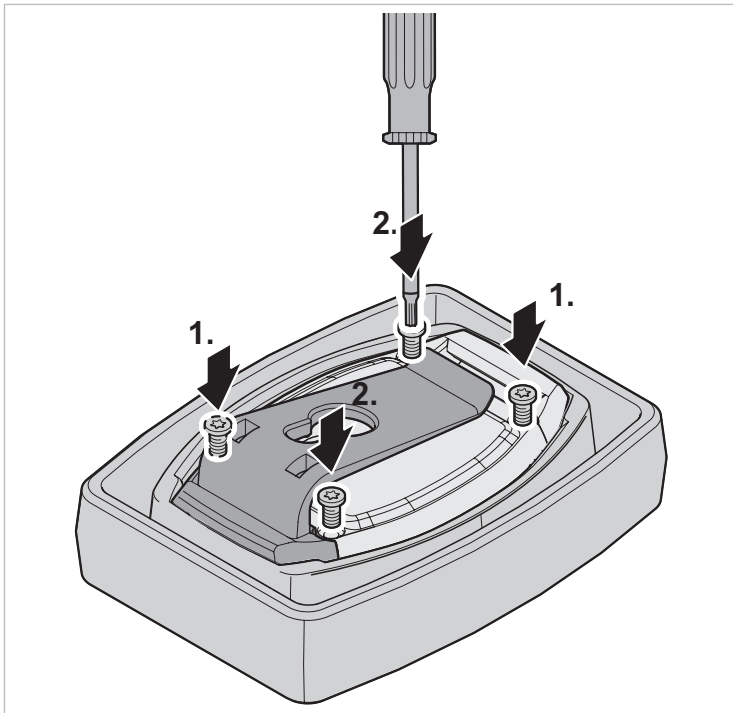

Fig. 19 Closing badge when attached to clip belt

### 5. Replacing the battery

The badge works with a CR2450 3 V 500 mAh battery.

1. Open the badge.  
See «4. Opening/closing the badge».
2. Carefully lift the printed circuit board by holding it by the edges.

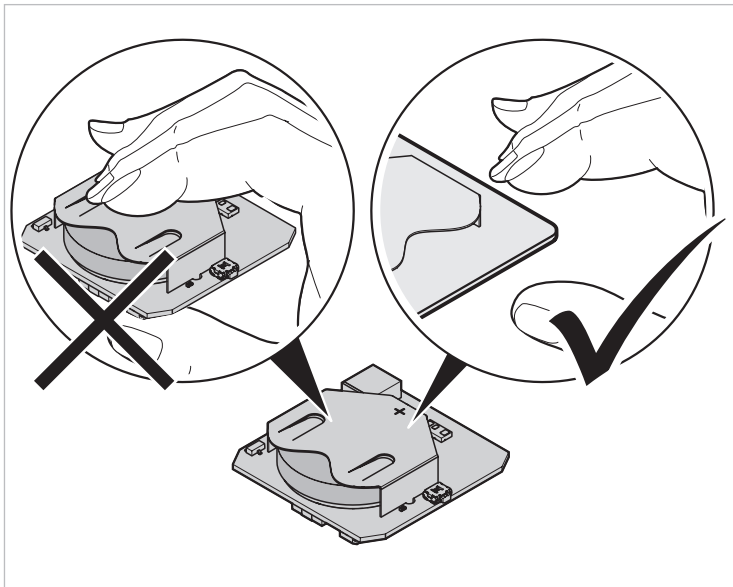

Fig. 20 Holding the printed circuit board by the edges

3. Remove the used battery. Push the battery out of its compartment with the help of e.g. a pencil.

 <b>CAUTION</b>	<p>Risk of damaging the device!</p> <ul style="list-style-type: none"> <li>▶ Do not touch the electronic circuit with a metallic tool.</li> </ul>
--------------------	---

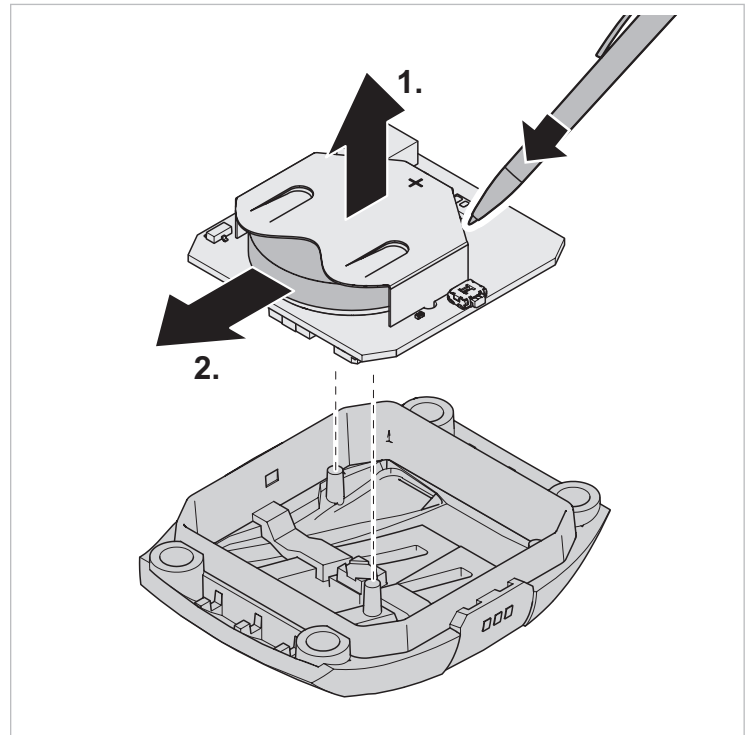

Fig. 21 Removing the battery

4. Place a new battery in the battery compartment. The + must point upwards.
5. Place the printed circuit board back in its housing. *The battery compartment opening must be at the top, next to the reassurance light (LED).*

	<p>▶ Make sure that the printed circuit board is placed in the right direction.</p>
--	---

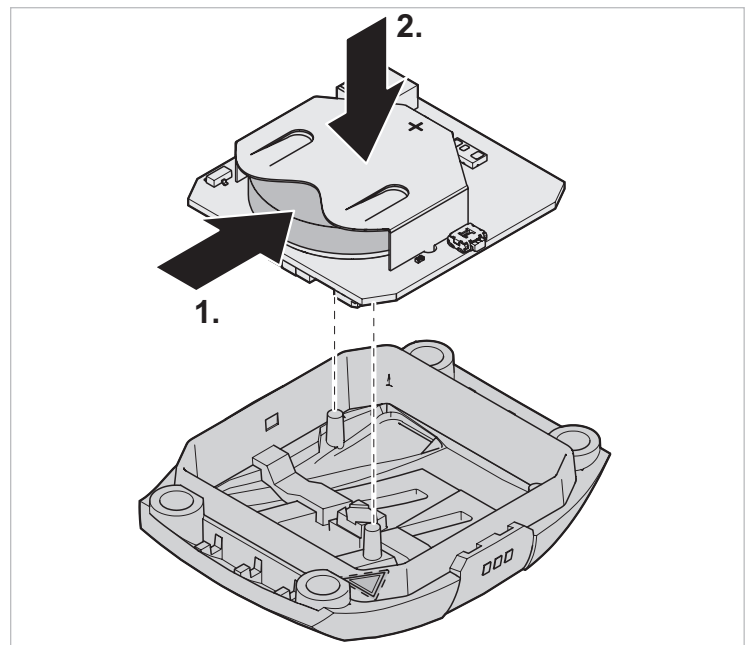

Fig. 22 Putting back the battery and the electronic circuit

6. Close the badge again.  
See «4. Opening/closing the badge».

## 6. Attaching an access chip

Optionally, an access chip can be attached.

### Attaching an access chip to bracelet

1. Remove the attached tab.
2. Put the tab with the access chip over the bracelet.

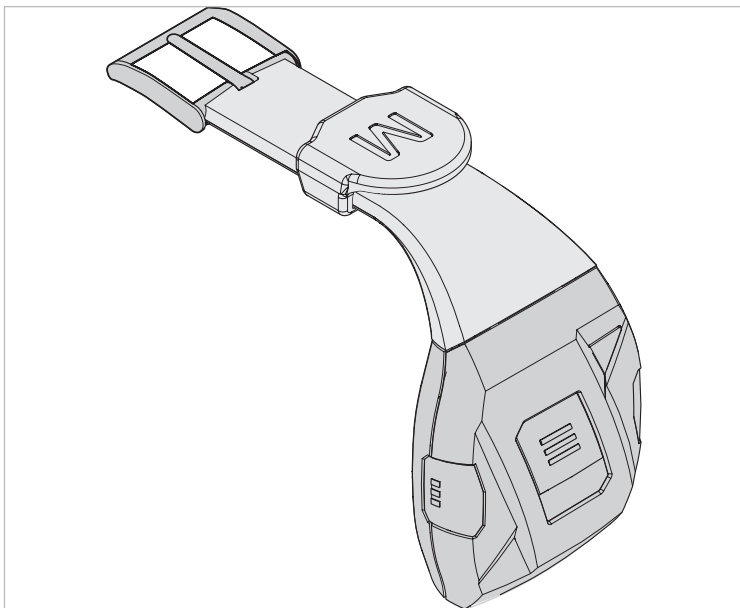

Fig. 23 Attaching the access chip to the bracelet

### Attaching an access chip to lanyard

- ▶ Put the tab with the access chip over the lanyard and push it up to the badge.

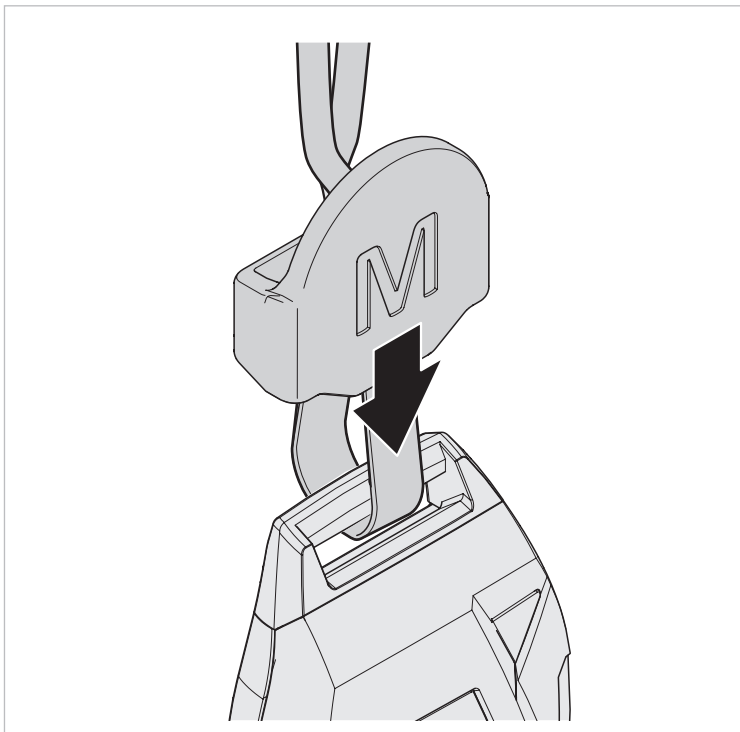

Fig. 24 Attaching the access chip to the lanyard

## 7. Care

- ▶ Replace the housing if it is cracked/broken.

### Cleaning



CAUTION

Risk of damage!

- ▶ Do not clean with ultrasound.
- ▶ Do not sterilise in an autoclave.
- ▶ Do not machine wash.

- ▶ Clean the badge regularly with a cloth and a 50% isopropyl alcohol solution.

## 8. Disposal



Directive DEEE 2012/19/CE on electrical and electronic equipment waste

- ▶ Dispose of the package and the end-of-life product in an appropriate recycling facility.
- ▶ Do not discard the product with household waste.
- ▶ Do not burn the product.
- ▶ Remove the battery.
- ▶ Recycle the battery in compliance with legal requirements and do not discard with household waste.



